

1

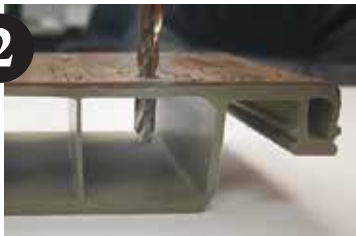

Place the Gorilla Deck Trim ("C"-Finish or "L"-Facsia) over the edge of the Gorilla Deck

2



Starting at one end of the Trim, drill a 1/4" hole every 16" to 18". DO NOT DRILL MORE THAN 1/2" DEEP.

The 1/4" holes need to be drilled through the Gorilla Deck Trim and the TOP OF THE GORILLA DECK BOARD ONLY.

FLIP OVER

3

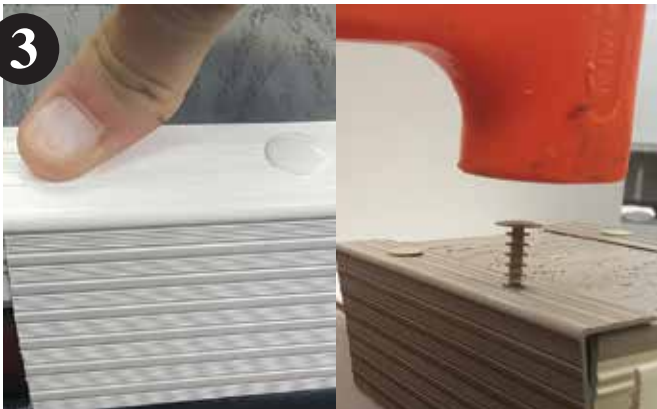

Place each Push Pin against the 1/4" pre-drilled hole. GENTLY push in with your thumb or tap the Push Pin into place using a non-marring mallet until it is level (flush) with the Gorilla Deck Trim.